

Three Phase Toroidal Transformer

三相环型变压器

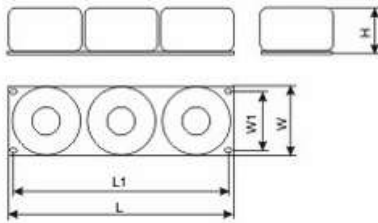

External Dimension 外形尺寸(A)

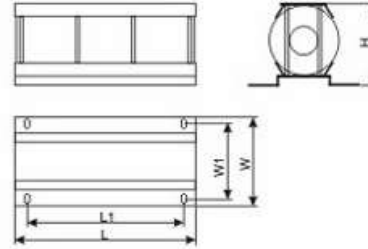

External Dimension 外形尺寸(B)

Wanji's Three-Phase Toroidal Transformer is high reliability with flexible connections. They are popular for Knitting machine, medical, energy, robotics and industrial power applications.

万吉三相环型变压器接受客户的定制，在纺织机、医疗、能源、机器人和工业电源有广泛应用。

■ SPECIFICATION 规格:

- Power Range 功率范围: 1KVA-30KVA
- Input/Output 输入/输出: Customized 客户定制
- Insulation Class 绝缘等级: UL class B, F, H, N. (Optional 可选)
- Isolation 隔离: 4KV (Hi-pot 耐压)

A:

Power 功率(VA)	L (mm)	L1 (mm)	W (mm)	W1 (mm)	H (mm)	Mounting Hole 安装孔(mm)	Weight 重量(kg)	Temperature Rise 温升(°C)
1000	360	345	115	95	75	Φ7*10	9.5	54
3000	480	465	150	130	95	Φ7*10	21.5	58

B:

Power 功率(VA)	L (mm)	L1 (mm)	W (mm)	W1 (mm)	H (mm)	Mounting Hole 安装孔(mm)	Weight 重量(kg)	Temperature Rise 温升(°C)
6000	460	405	210	180	270	Φ9*15	40	62
9000	460	405	210	180	285	Φ9*15	54	64
15000	480	425	231	196	300	Φ10.6*30	80	65
25000	500	445	241	206	320	Φ10.6*30	100	66
30000	530	475	265	230	360	Φ10.6*30	120	68

Remark: All data are subjected to modification without prior notice.
 备注: 未经通知可自行调整参数。